

# PROJECT INFORMATION

**APPLICANT:**  
STEPHEN & ELIZABETH ROSENMAN

**DRAWINGS BY:**  
ECCO DESIGN INC.  
7413 GREENWOOD AVE N  
SEATTLE, WA 98103  
206-706-3937

**SITE ADDRESS:**  
8260 AVALON DR  
MERCER ISLAND, WA 98040

**PARCEL NUMBER:**  
312405-9037

**BODY OF WATER:**  
LAKE WASHINGTON

**LEGAL DESCRIPTION:**  
POR OF NW 1/4 OF NW 1/4 & OF GL 1 BEG 2084.82 FT E OF NW COR OF SEC TH S 00-09-44 W 50 FT TH S 51-12-30 E 25 FT TH S 38-47-30 W 506 FT TH ALG CURVE TO LEFT RAD 103.11 FT DIST OF 53.18 FT TO PT OF REVERSE CURVE TH ALG CURVE TO RT RAD 330 FT DIST OF 97.21 FT TO PT OF COMP CURVE TH ALG CURVE TO RT RAD 651.46 FT DIST OF 391.59 FT TH S 60-33-29 W 209.43 FT TO TPOB TH CONTG S 60-33-29 W 60.85 FT TH S 39-01-51 E 401.95 FT TH S 89-50-16 E 65.97 FT TH N 32-11-59 E 9.37 FT TH N 39-01-51 W 429.16 FT TO TPOB

**PROJECT DESCRIPTION:**  
REPAIR AN EXISTING PIER BY RE-DECKING WITH THRUFLOW GRATED DECKING (43% OPEN SPACE) AND REPLACING FASCIA.

# VICINITY MAP

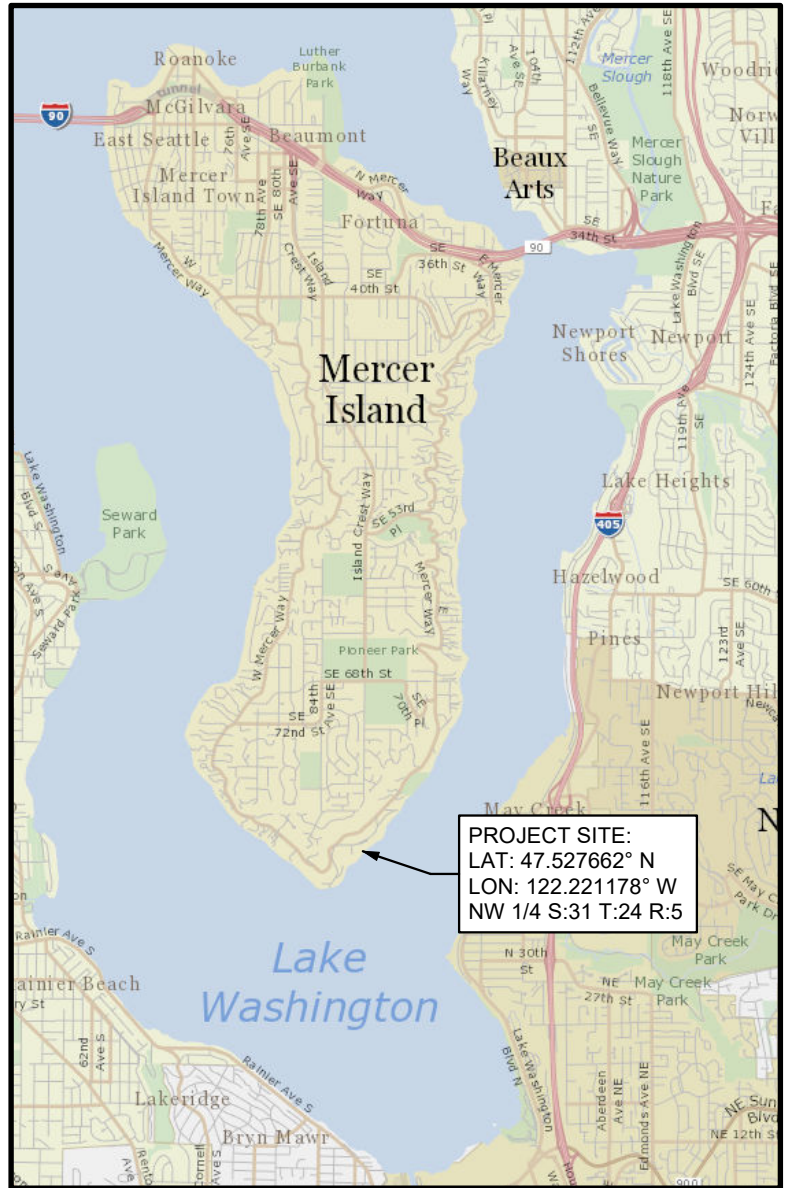

## REFERENCE:

**DATUM:** C.O.E. Locks Datum

## ADJACENT PROPERTY OWNERS:

1. Erik Lund
2. Michael & Susan Cero

**APPLICANT:** Stephen & Elizabeth Rosenman

**LOCATION:** 8260 Avalon Dr  
Mercer Island, WA 98040

**LAT/LONG:** 47.527662°/-122.221178°

## PROPOSED PROJECT:

Repair Pier  
**IN:** Lake Washington  
**NEAR/AT:** Mercer Island  
**COUNTY:** King **STATE:** WA

**SHEET** 1 of 5

**DATE:** April 6, 2026

PLEASE NOTE THAT THE SHORELINE CONFIGURATION AND PROPERTY LINE LOCATIONS ARE APPROXIMATE ONLY. PROPERTY LINES AND SHORELINE ARE BASED ON KING COUNTY GIS..

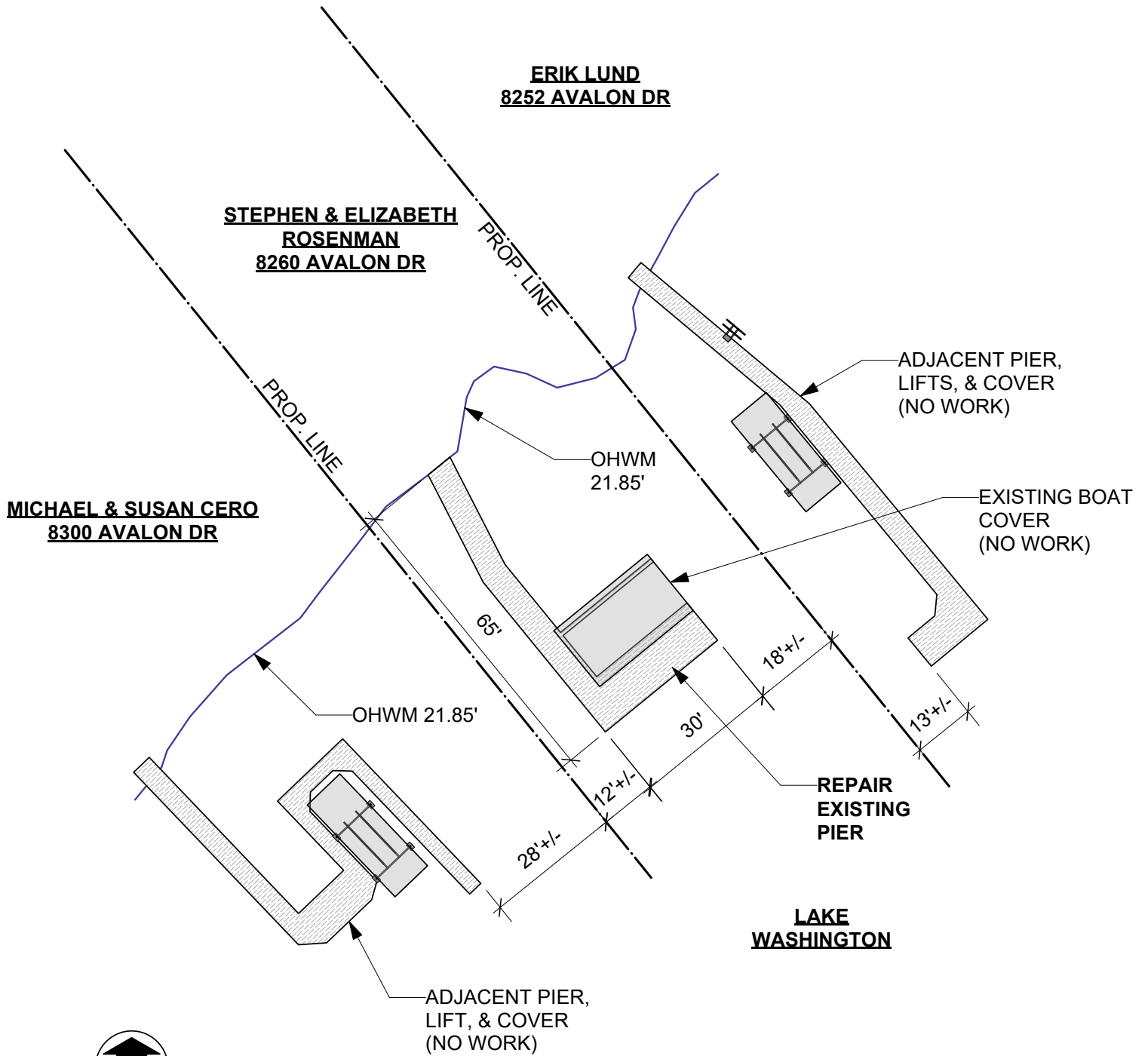

# SITE PLAN

SCALE 1" = 30'-0"



Reference:  
Applicant: Stephen & Elizabeth  
Rosenman  
Proposed: Repair Pier  
Location: Mercer Island, WA

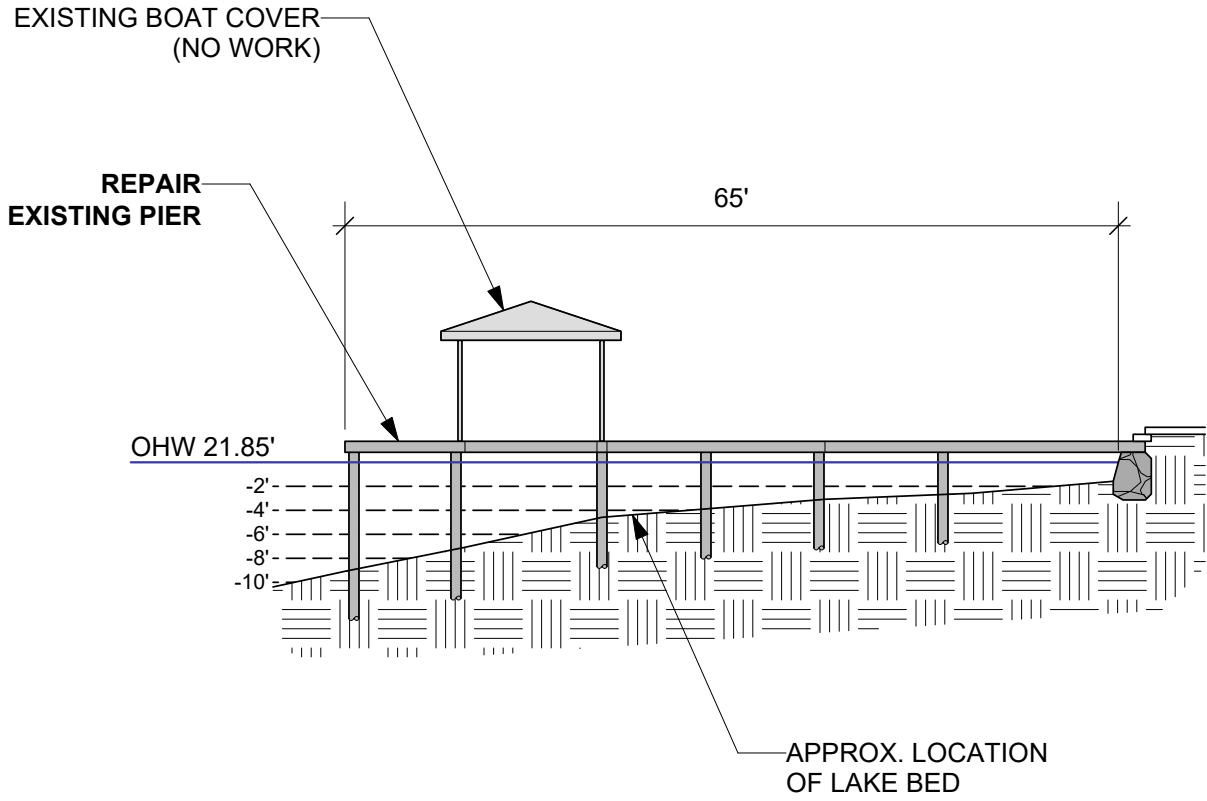

# **PIER ELEVATION**

SCALE 1/16" = 1'-0"



**Reference:**  
**Applicant:** Stephen & Elizabeth  
 Rosenman  
**Proposed:** Repair Pier  
**Location:** Mercer Island, WA

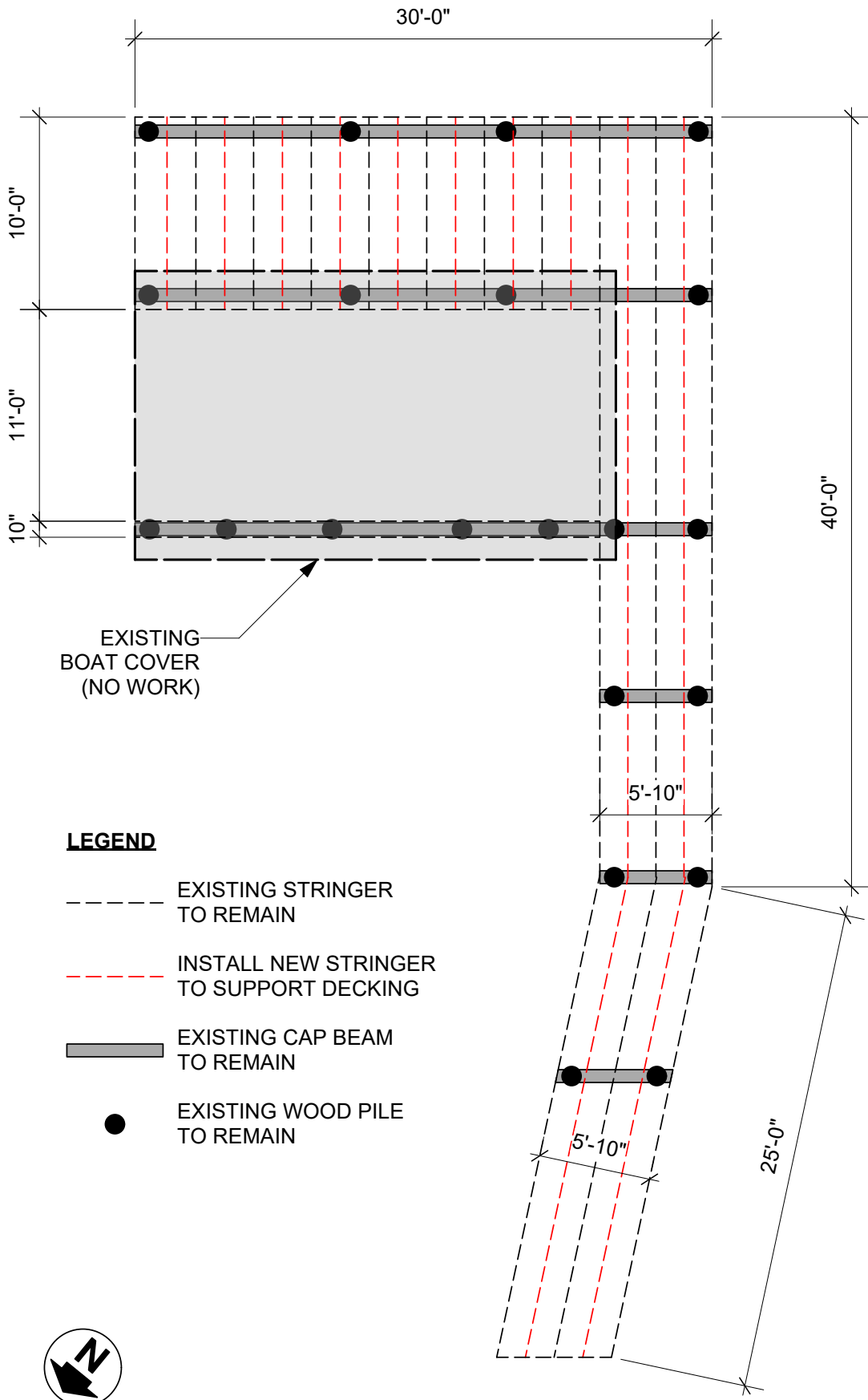

**LEGEND**

- EXISTING STRINGER TO REMAIN
- - - - - INSTALL NEW STRINGER TO SUPPORT DECKING
- █ EXISTING CAP BEAM TO REMAIN
- EXISTING WOOD PILE TO REMAIN



**PIER REPAIR PLAN**

SCALE 1/8" = 1'-0"



**Reference:**  
**Applicant:** Stephen & Elizabeth Rosenman  
**Proposed:** Repair Pier  
**Location:** Mercer Island, WA

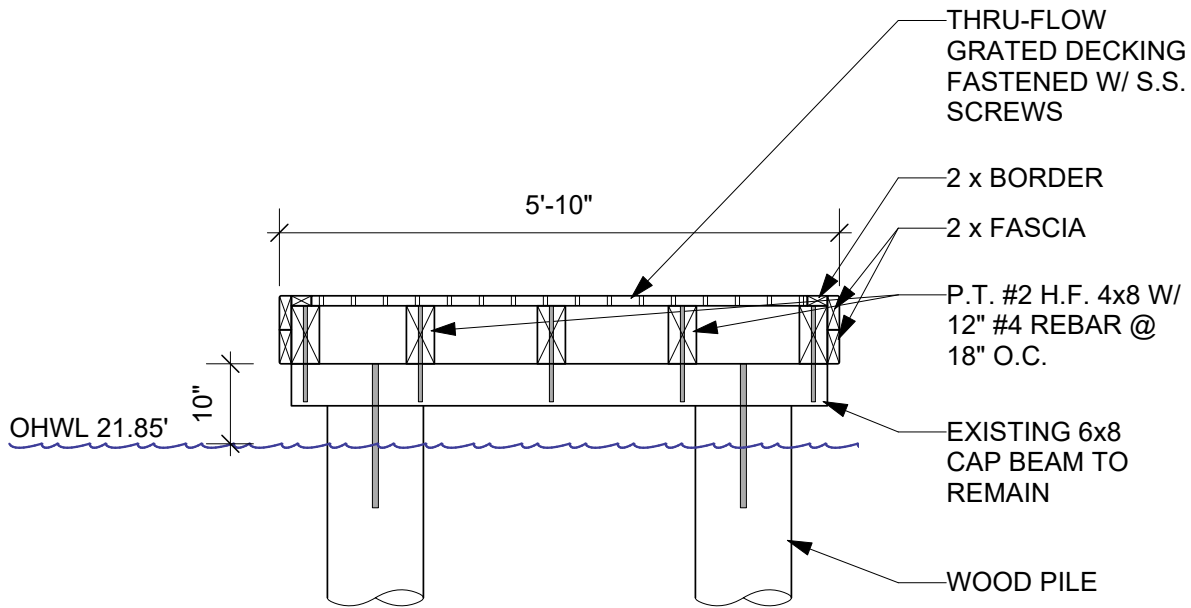

## **PIER SECTION - A**

SCALE 1/2" = 1'-0"



**Reference:**  
**Applicant:** Stephen & Elizabeth  
 Rosenman  
**Proposed:** Repair Pier  
**Location:** Mercer Island, WA

**Sheet 5 of 5**    **Date:** 4/6/2026